



TO LET: INDUSTRIAL / WAREHOUSE PREMISES

Alton East: 204 sq m / 2,200 sq ft

Location: Marlborough is a market town and civil parish in the English county of Wiltshire on the Old Bath Road, the old main road from London to Bath. The town is on the River Kennet, 24 miles north of Salisbury and 10 miles southeast of Swindon.

Elcot Park has excellent communication links to the whole of the M4, Devizes, Swindon, Newbury and Andover. It is particularly close to Marlborough College, Salisbury Plain and Stonehenge.

Description: Alton East is large enough for those business and organisations who need a combination of space. The main entrance is completely undercover making loading & unloading deliveries extremely convenient via a large roller shutter door. The premises are constructed with blockwork inner walls. The pitched roof incorporating daylight panels is supported on a steel portal frame. Internally, the ground floor is concrete and there are personnel doors in the front and rear elevations. Externally, parking is available on a concrete forecourt at the rear of the premises. Additional office space is also available in the Avening Office Suite.

Summary of Accommodation:

Premises size:	204 sq m / 2,200 sq ft	Height:	5.3m (eaves) & 7.3m (ridge)
Access:	Elcot Lane, off London Road 24/7/365	Roller Shutter:	3m wide x 3m high
Electric:	Metered supply (3 phase)	Cadley 3 Unit:	Is also available (see map)
Water:	Metered supply		
Parking:	Additional parking available		
Offices:	Office space available in the Avebury Office Suite		



Site Manager: Jen Saunders 07443 293830

www.elcot-park.co.uk

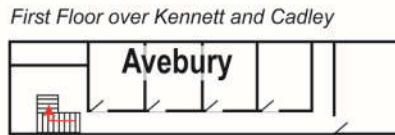

ELCOT PARK

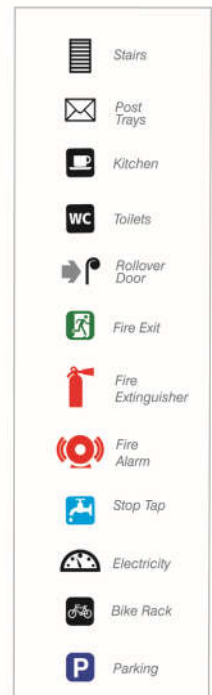
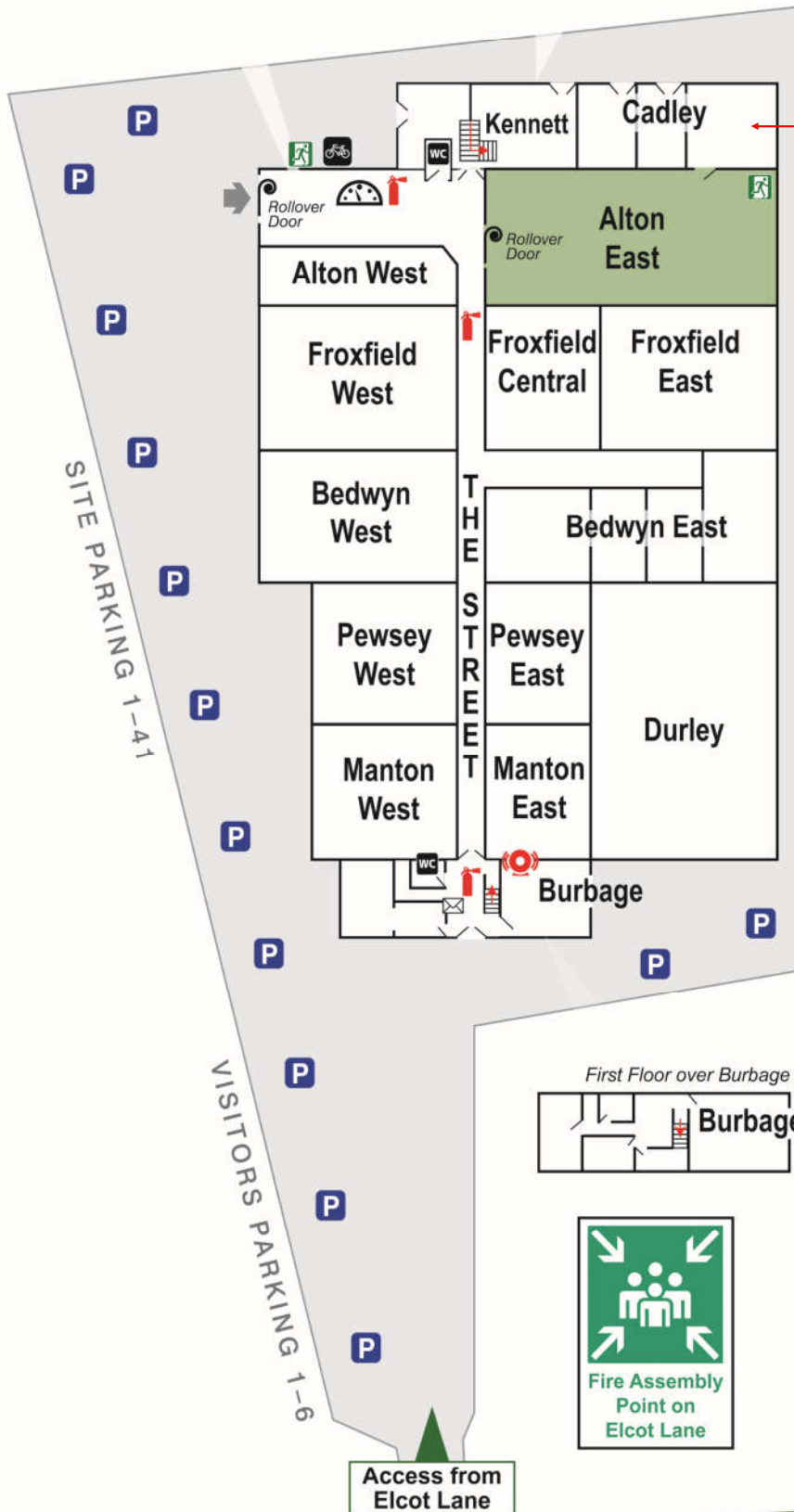

Please note:
CCTV is
in operation

Site Manager

Jen Saunders : 07443 293830

Enquiries & Site Owner

George Estates Ltd. : 01666 828903

info@elcot-park.co.uk

www.elcot-park.co.uk